

# Low-rise floor plan

## Indicative (L13)

33,361 sq ft / 3,099.3 sq m

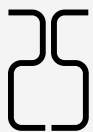
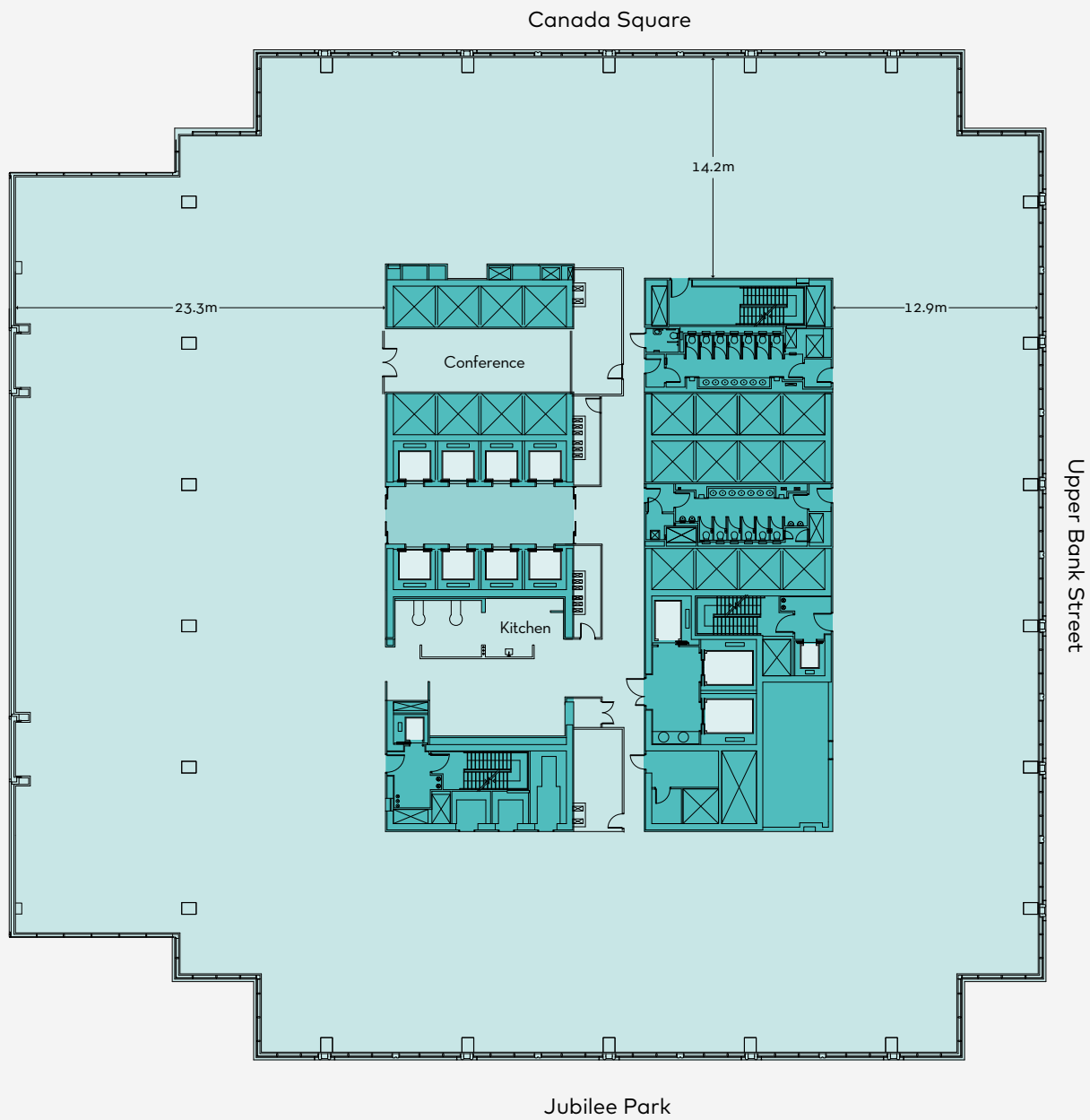

CANADA SQUARE  
CANARY WHARF



R = Riser room  
Floor plans not to scale

# Mid-rise floor plan

## Indicative (L23)

30,581 sq ft / 2,841.1 sq m

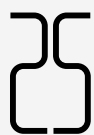
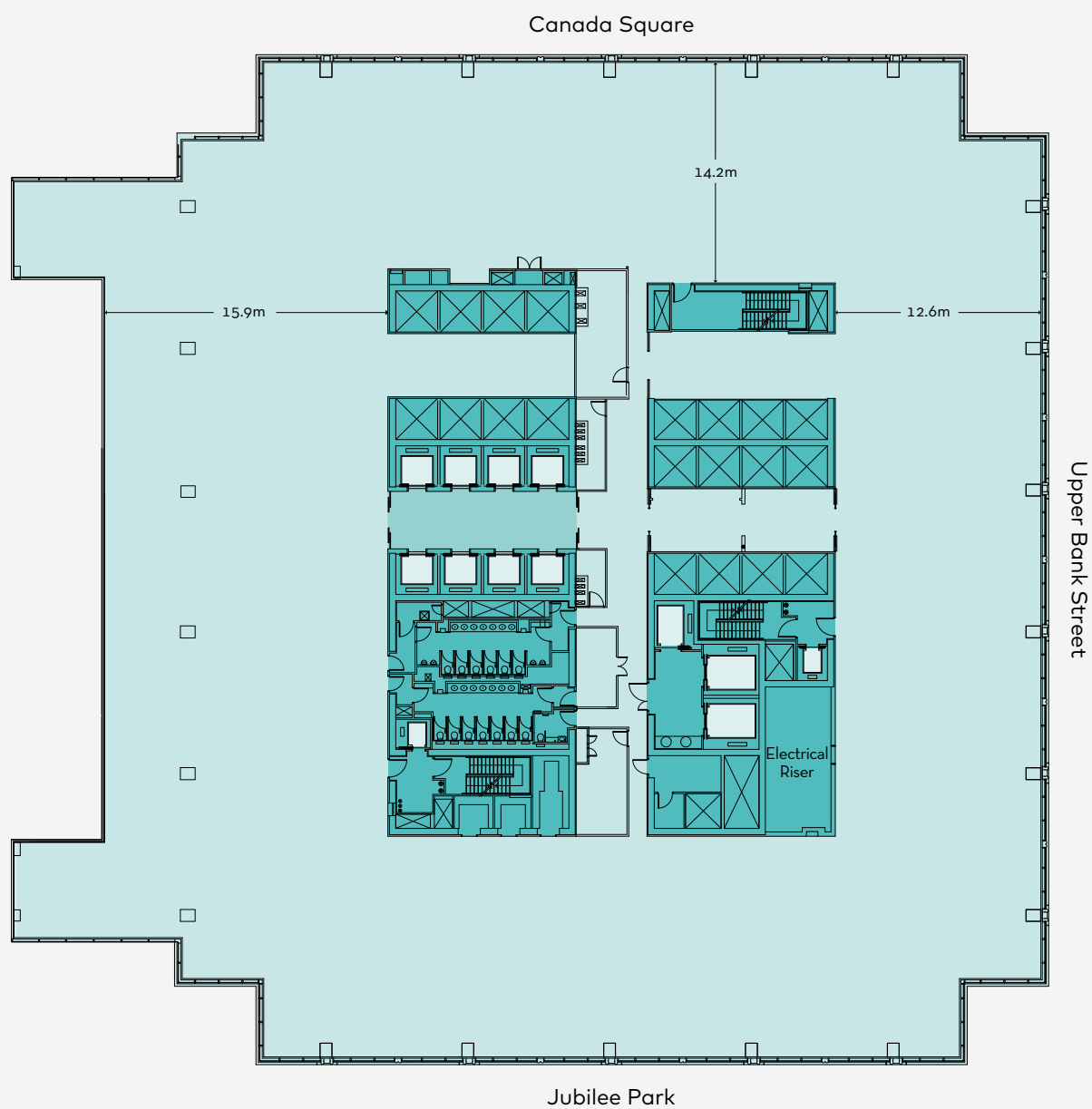

CANADA SQUARE  
CANARY WHARF



R = Riser room  
Floor plans not to scale

# High-rise floor plan

## Indicative (L30)

28,361 sq ft / 2,634.8 sq m

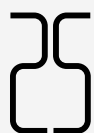
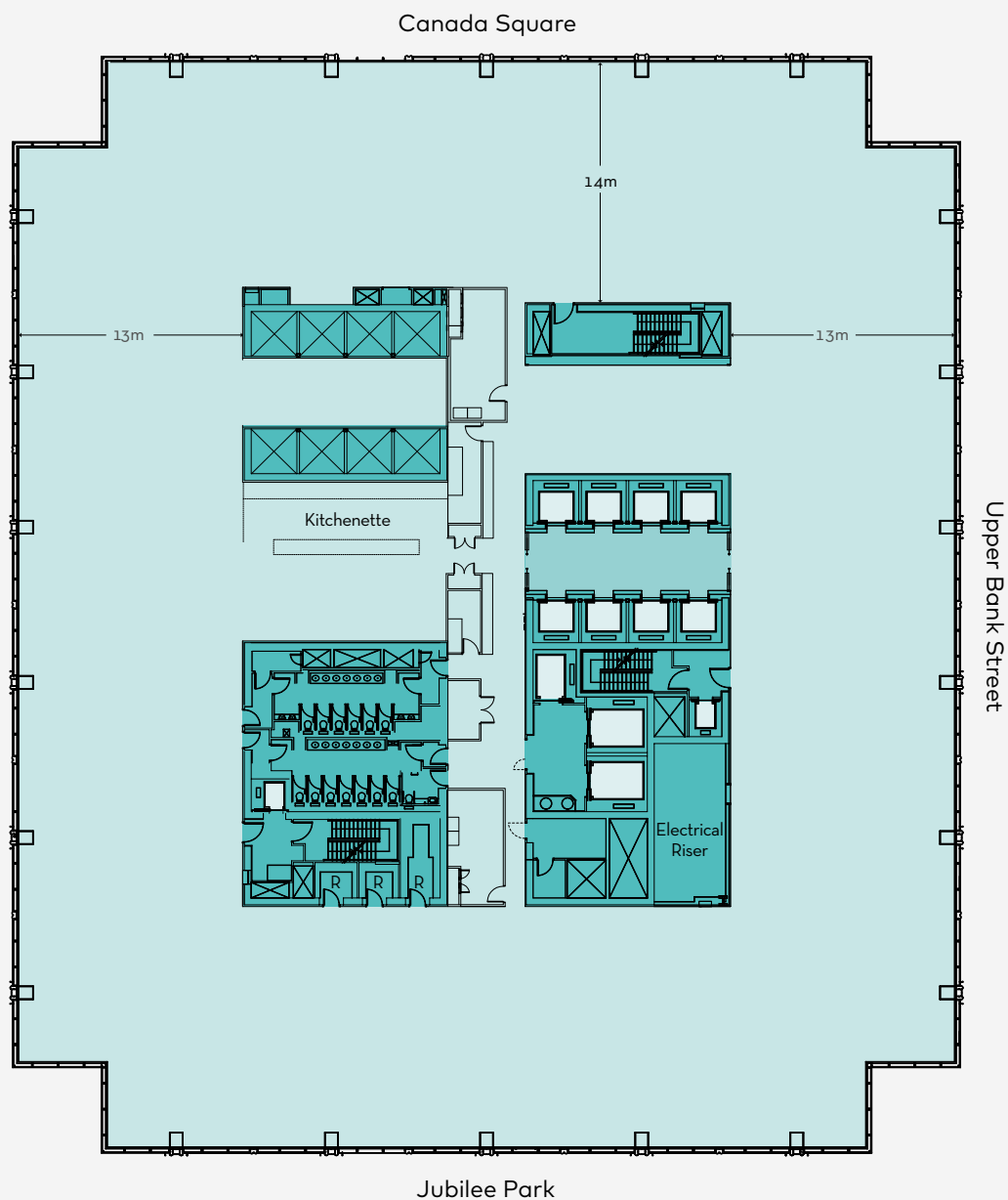

CANADA SQUARE  
CANARY WHARF



R = Riser room  
Floor plans not to scale

# High-rise floor plan

## Indicative (L37)

27,889 sq ft / 2,591.0 sq m

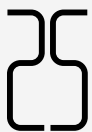
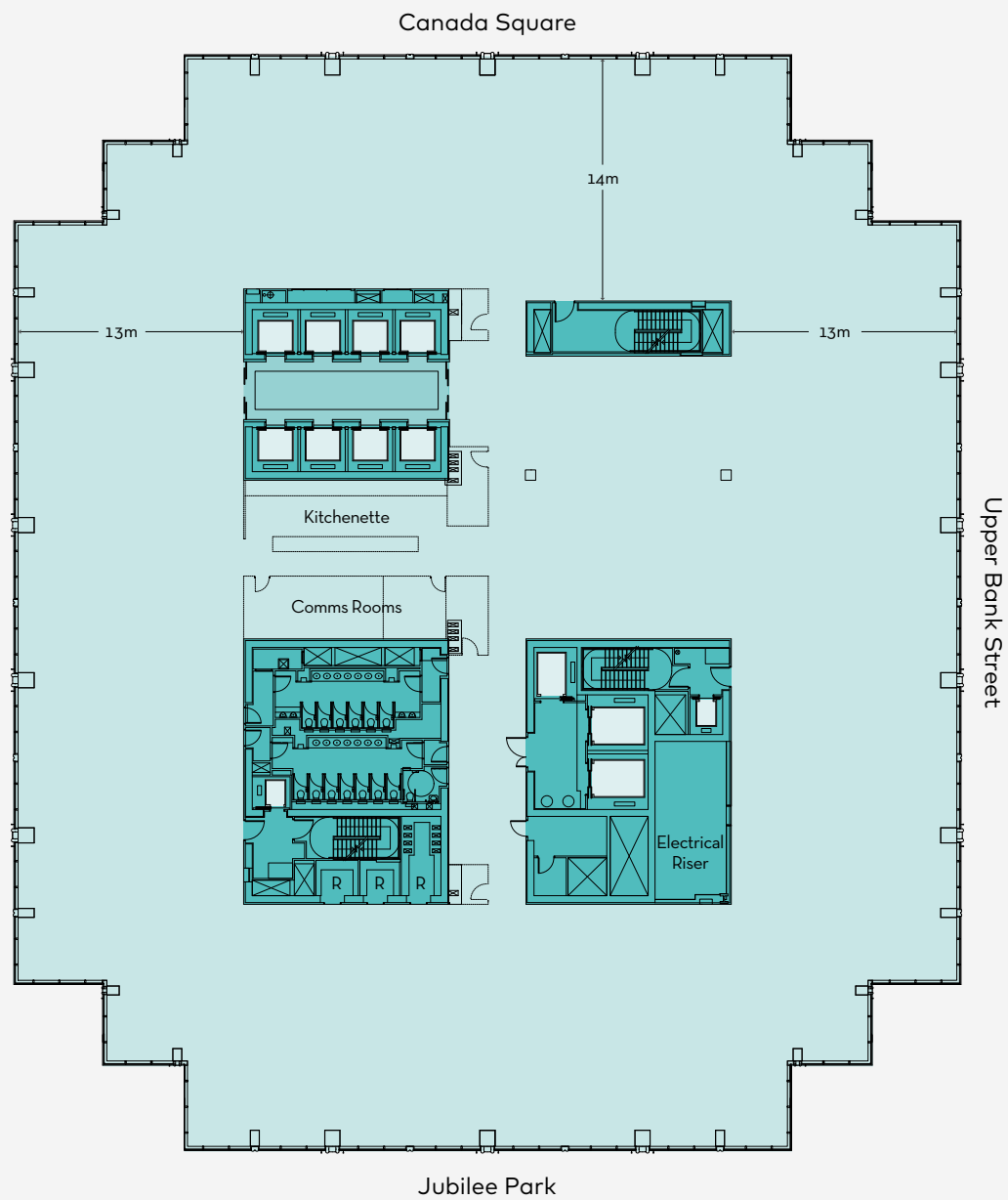

CANADA SQUARE  
CANARY WHARF



R = Riser room  
Floor plans not to scale

# High-rise floor plan

## Indicative (L42)

19,666 sq ft / 1,827.0 sq m

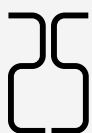
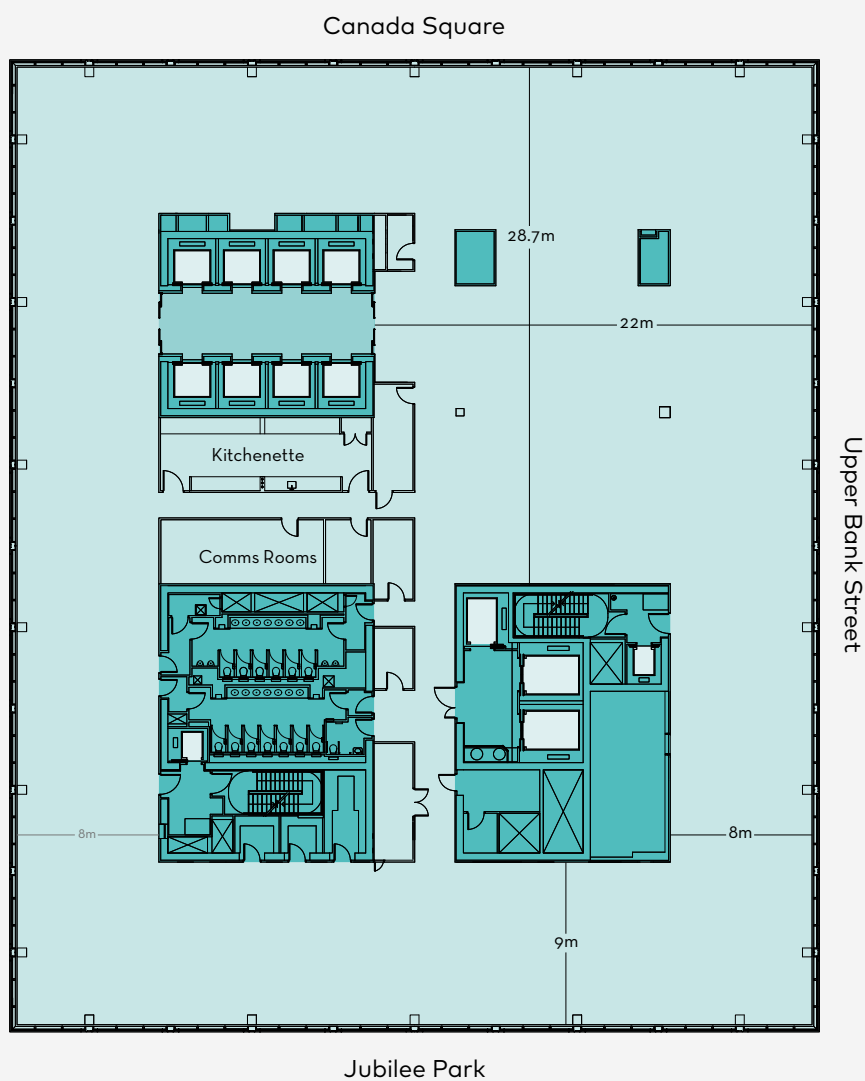

CANADA SQUARE  
CANARY WHARF



R = Riser room  
Floor plans not to scale